

# Installation Instructions Concrete & Solid Floor

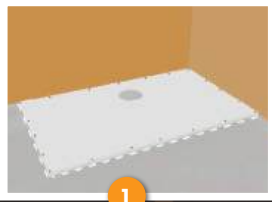

1

Locate Tuffdeck in the corner to which it is going to be finally positioned & mark lines around the outer edge. If cutting to size use a circular saw or jigsaw.



2

Excavate the floor within the marked area to a sufficient depth of 24mm to accept Tuffdeck.



3

Ensure Tuffdeck fits neatly into the recess. Mark shower trap position.



4

Remove Tuffdeck. Decide upon the position of the waste pipe knocking out a hole in the adjacent wall if required. It will be necessary to remove an area to sufficient depth under the outlet position to accommodate the shower trap. (Approximate trap depth 95mm x 110mm wide). The trap must be fully supported underneath with a self levelling screed mix.

## METHOD 1

(As shown in points 5 & 5a) Set the trap body into the floor. Place the trap flange into Tuffdeck ensuring it finishes flush with, or just below the surface on which the sheet flooring is to be laid.

Attach flange to the trap body using the 4 bolts provided, ensure the rubber seal is in place. Secure flange to Tuffdeck, there are 4 off csk indentations in the flange to assist with this. Connect trap to waste pipe for outflow drain.

## METHOD 2

Fully assemble the trap to Tuffdeck (as described above) before placing in position, also attaching a length of pipework ready for connection to the waste / soil pipe. If you are using a pump, the fitting of the shallower pumped trap is the same as described above.

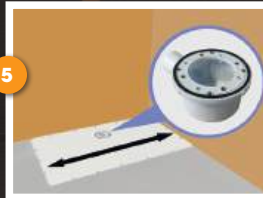

5

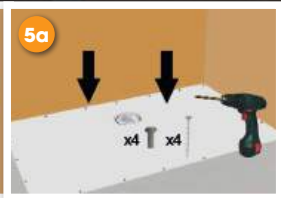

5a

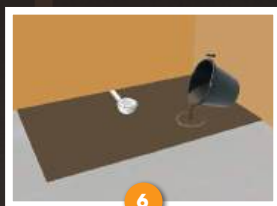

6

Apply a self levelling screed mix to cover all of the proposed area. This will ensure Tuffdeck is fully supported. Caution! Ensure the void around the trap body is also filled. DO NOT rely solely on support from under the flange.



7

Circular ribbed underside allows Tuffdeck to settle on a cement or screed base eliminating slippage during installation. Carefully place Tuffdeck into position. Checking levels in both directions, gently tap Tuffdeck down until level on all 4 sides. It may be necessary to add more self levelling screed, do this by slightly lifting Tuffdeck & pouring in the screed.

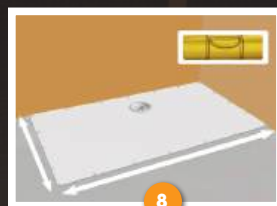

8

It is important that Tuffdeck is level on all 4 sides when fitted & then left to set. **TIP:** Filling the Tuffdeck / floor joint & the screw ports using a resin car body filler or similar will form a strong bond between Tuffdeck & the bathroom floor as well as prevent indentations appearing in the floor covering.



9

At this stage you will now be ready to bond into position the relevant coverings & floor coverings.

**NOTE:**  
Bond vinyl sheet flooring to the floor using a 2 part water resistant adhesive. All flooring should be installed in accordance with the manufacturers guidelines.



10

Once the floor covering is laid, screw into position the trap clamping ring using the bolts provided, ensuring the inner cup & dip tube can still be removed. Fit the shower traps push on cover plate.

# Installation Instructions Wooden Floors



1

Locate Tuffdeck in the corner to which it is going to be finally positioned and mark lines around the outer edge. If cutting to size use a circular saw or jigsaw.



2

Remove the floor within the marked area to a depth of 18mm to accept Tuffdeck. Ensure the joists provide a secure and flat surface for the Tuffdeck. It may be necessary to use packing on the joists to ensure the Tuffdeck is level.

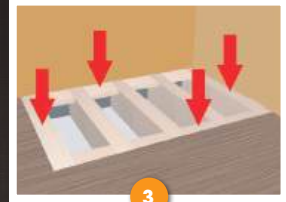

3

Use noggins to support all outer edges of the Tuffdeck as shown above.

**IT IS NOT NECESSARY TO USE ADDITIONAL NOGGINS AROUND THE WASTE POSITION.**

NOTE: If the floorboards are 18mm thick you would need 6mm plywood to make the Tuffdeck and floor absolutely level in order to apply your floor covering.



4

Connect the trap body to your outlet pipework, position between joists and centrally beneath the hole in the Tuffdeck. Ensure the trap is fully supported underneath.

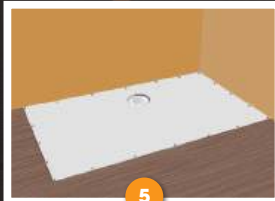

5

Place the Tuffdeck in position.



6

Attach flange to the trap body using the 4 bolts provided, ensuring that the rubber seal is in place. Secure flange to Tuffdeck, there are 4 countersunk indentations in the flange to assist with this.

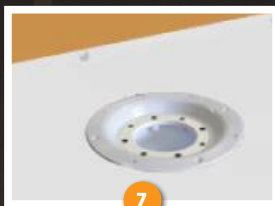

7

Also ensure that the flange on the trap body is level with, or slightly below the Tuffdeck once in its correct position and that the rubber seal is in place.

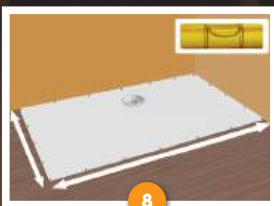

8

Ensure that the Tuffdeck is well supported and completely level.

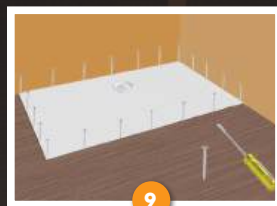

9

Use the longer screws provided to secure the Tuffdeck to the floor joists. Ensure Tuffdeck is secured along all 4 edges to eliminate any movement. **IT IS NOT NECESSARY TO PILOT DRILL THROUGH THE SCREW PORTS.**

**TIP:** Fill the joint, using a resin car body filler or similar to form a strong bond between the Tuffdeck & the floor.



10

At this stage you will now be ready to bond into position the relevant covings and floor coverings.

**NOTE:**

Bond vinyl sheet flooring to the floor using a 2 part water resistant adhesive. All flooring should be installed in accordance with the manufacturers guidelines.



11

Once the floor coving is laid, screw into position the traps clamping ring using the bolts provided ensuring the inner cup and dip tube can still be removed. Fit the shower traps push on cover plate.